

# autonox24 Hygienic Design DELTA robot mechanics <sup>1)</sup>

<div> <div>Axes[N°]</div> <div> <div>Payload</div> <div> <div>[kg]</div> <div>[lbs]</div> </div> </div> </div>		3 (DELTA "RL...")				4 (DELTA "RL...")			
		Ø		Article number	Features	Ø		Article number	Features
		Work.- Area				Work.- Area			
		[mm]	[inch]			[mm]	[inch]		
1	2.20	800	31.49	A_00003-Ti		800	31.49	A_00012-01-Ti	<sup>2)</sup>
		1100	43.31	A_00022-Ti		1100	43.31	A_00032-02-Ti	<sup>2)</sup>
3						800	31.49	A_00017-01-Ti	<sup>2)</sup>
						1100	43.31	A_00018-02-Ti	<sup>2)</sup>
6	13.23	1200	47.24	A_00025		1000	39.37	A_00027-01	<sup>2)</sup>
						1200	47.24	A_00026-02	<sup>2)</sup>

DELTA 3/4 axes for 1 kg payload

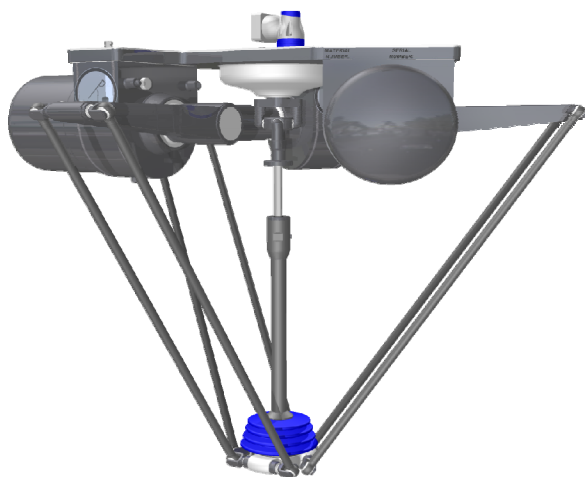

DELTA 3/4 axes for 6 kg payload



<sup>1)</sup> Please see separeate overview for **autonox24** standard robot mechanics.

<sup>2)</sup> Internal media supply is not possible.

# autonox24 Hygienic Design DuoPod robot mechanics <sup>1)</sup>

Payload Axes[N°]		2 (DuoPod "RV...")			
		Width (x) Work.- Area		Article number	Features
		[mm]	[inch]		
[kg]	[lbs]				
0,5	1.10	300	11.81	A_00097	<sup>2)</sup>
350	771.62	300	11.81	A_00098	<sup>2)</sup>

DuoPod

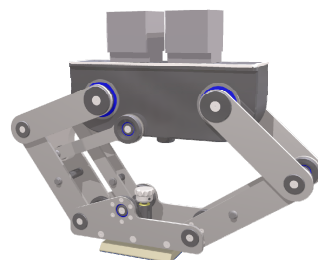

<sup>1)</sup> Please see separate overview for **autonox24** standard robot mechanics.

<sup>2)</sup> Internal media supply is not possible.

# autonox24 STANDARD DELTA robot mechanics (payload 0,5 kg - 3 kg) <sup>1)</sup>

Axes[N°]  Payload		3 (DELTA "RL...")				4 (DELTA "RL...")				5 (DELTA "RL..." ) <sup>2)</sup>							
		Ø Work.- Area		Article number	Features	Ø Work.- Area		Article number	Features	Ø Work.- Area		Article number	Features				
[kg]	[lbs]	[mm]	[inch]			[mm]	[inch]			[mm]	[inch]						
0,5	1.10	200	7.87	A_00803	<sup>2)</sup>	200	7.87	A_00807	<sup>2)</sup>								
		400	15.75	A_00800	<sup>2)</sup>	400	15.75	A_00806	<sup>2)</sup>								
1	2.20	600	23.62	A_00072		600	23.62	A_00082		750	29.53	A_00083					
				A_00072-T1	<sup>2)</sup>			A_00082-01	With reinforced tool holder <sup>3)</sup>	1350	53.15	A_00045					
				A_00072-TS1	<sup>2)</sup>			A_00082-01-CR	For clean-room applications <sup>3)</sup>								
		900	35.43	A_00085				A_00082-02	With reinforced tool holder <sup>3)</sup> and reinforced fourth axis with reduced backlash								
				A_00062					A_00082-03					With reinforced tool holder <sup>3)</sup> and reduced backlash in the fourth axis			
				A_00062-01	With reinforced tool holder <sup>3)</sup>												
				A_00062-02	Without telescopic tube <sup>2) 4)</sup>												
				A_00062-02	With reinforced tool holder <sup>3)</sup>												
					A_00062-T1			With 1x tool-actuation 'T' <sup>2) 3)</sup>									
								800	31.49					A_00084			
								900	35.43					A_00088			
														A_00088-01	With reinforced tool holder <sup>3)</sup>		
								1200	47.24					A_00042			
														A_00042-01	With reinforced tool holder <sup>3)</sup>		
														A_00042-02	With reinforced tool holder <sup>3)</sup> and reduced backlash in the fourth axis <sup>2)</sup>		
															A_00042-T1	With 1x tool-actuation 'T' <sup>2)</sup>	
		3	6.61	600	23.62			A_00811		600	23.62	A_00034		1350	53.15	A_00801-01	
				900	35.43			A_00033				A_00034-T1	<sup>2)</sup>	1550	61.02	A_00815-01	
A_00033-T1	<sup>2)</sup>					900	35.43	A_00037									
A_00033-T2	<sup>2)</sup>							A_00037-01	<sup>2)</sup>								
A_00035				A_00037-T1	<sup>2)</sup>												
1200	47.24			A_00035-01	Without telescopic tube <sup>2) 4)</sup>	1200	47.24	A_00036									
				A_00035-T1	With 1x tool-actuation 'T' <sup>2)</sup>			A_00036-01	<sup>2)</sup>								
1600	62.99			A_00810		1600	62.99	A_00805									
									A_00805-T1					With 1x tool-actuation 'T' <sup>2)</sup>			

DELTA 3/4 axes



DELTA 5 axes



<sup>3)</sup> Reinforced tool holder

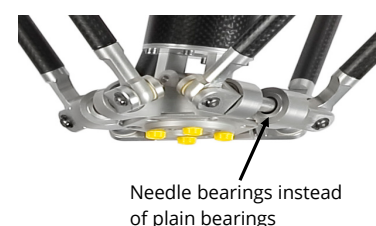

Tool-actuation 'TS'

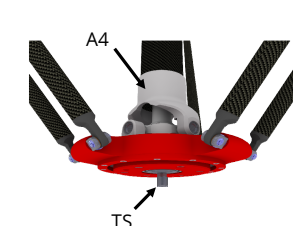

<sup>4)</sup> Without telescopic tube



<sup>1)</sup> Please see separate overview for autonox24 hygienic design robot mechanics.

<sup>2)</sup> Internal media supply is not possible.

# autonox24 STANDARD DELTA robot mechanics (payload 6 kg - 50 kg) <sup>1)</sup>

Axes[N°]  Payload		3 (DELTA "RL..." )				4 (DELTA "RL..." )				5 (DELTA "RL..." ) <sup>2)</sup>				
		Ø Work.- Area		Article number	Features	Ø Work.- Area		Article number	Features	Ø Work.- Area		Article number	Features	
		[mm]	[inch]			[mm]	[inch]			[mm]	[inch]			
6	13.23	900	35.43	A_00086-T1	1)	900	35.43	A_00804	2)	1450	57.09	A_00802		
				A_00086-TS1	With 1x tool-actuation 'TS' <sup>2)</sup>			A_00804-ATS		1900	74.08	A_00808		
		1200	47.24	A_00050		1200	47.24	A_00052-01	2)					
				A_00050-01	Without telescopic tube <sup>2) 4)</sup> With increased tilt capacity			A_00052-02	With reinforced fourth axis					
				A_00050-02	Without telescopic tube <sup>2) 4)</sup>	1300	51.18	A_00053						
				A_00050-T1	With 1x tool-actuation 'T' <sup>2)</sup>			A_00053-ATS	With automatic tool system <sup>2)</sup>					
				A_00050-T1-01	With 1x tool-actuation 'T' <sup>2)</sup> With increased tilt capacity			A_00053-T1	With 1x tool-actuation 'T' <sup>2)</sup>					
				A_00050-TS1	With 1x tool-actuation 'TS' <sup>2)</sup>			A_00053-TS1	With 1x tool-actuation 'TS' <sup>2)</sup>					
				A_00050-TS1-ATS	With 1x tool-actuation 'TS' <sup>2)</sup> With automatic tool system			A_00053-TS1-ATS	With 1x tool-actuation 'TS' <sup>2)</sup> With automatic tool system					
		1300	51.18	A_00051-01	2) 4)	1400	55.12	A_00054-02	With reinforced fourth axis					
				A_00051-T1	With 1x tool-actuation 'T' <sup>2)</sup>			A_00054-ATS						
				A_00051-TS1	With 1x tool-actuation 'TS' <sup>2)</sup>									
				A_00051-TS1-ATS	With 1x tool-actuation 'TS' <sup>2)</sup> With automatic tool system									
		1400	55.12	A_00055-ATS										
		12	26.46	2000	78.74	A_00809						1400	55.12	A_00816
								1650	64.96	A_00817				
20	44.09	1200	47.24	A_00064-T1	2)	1400	55.12	A_00065	2)					
				A_00064-TS1	With 1x tool-actuation 'TS' <sup>2)</sup>			A_00065-T1	With 1x tool-actuation 'T' <sup>2)</sup>					
		1400	55.12	A_00063		1600	62.99	A_00067	2)					
				A_00063-T1	With 1x tool-actuation 'T' <sup>2)</sup>			A_00067-T1	With 1x tool-actuation 'T' <sup>2)</sup>					
		1600	62.99	A_00066				A_00067-TS1	With 1x tool-actuation 'TS' <sup>2)</sup>					
				A_00066-T1	With 1x tool-actuation 'T' <sup>2)</sup>			A_00067-TS1-ATS-01	2)					
				A_00066-TS1	With 1x tool-actuation 'TS' <sup>2)</sup>			A_00067-TS1-ATS-02	2)					
50	110.23					1600	62.99	A_00070-T1	2)					

DELTA 3/4 axes



DELTA 5 axes



<sup>3)</sup> Reinforced tool holder

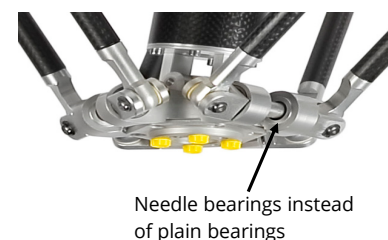

Tool-actuation 'TS'

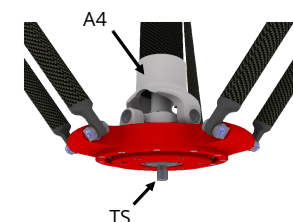

<sup>4)</sup> Without telescopic tube



<sup>1)</sup> Please see separate overview for autonox24 hygienic design robot mechanics.

<sup>2)</sup> Internal media supply is not possible.

# autonox24 STANDARD DuoPod robot mechanics <sup>1)</sup>

Axes[N°]  Payload		2 (DuoPod "RV..." / "RVS...")				3 (DuoPod "RV..." / "RVS...")			
		Width (x) Work.- Area		Article Number	Features	Width (x) Work.- Area		Article Number	Features
		[mm]	[inch]			[mm]	[inch]		
3	6.61					750	29.53	A_00900-T1	With 1x tool-actuation 'T' <sup>2)</sup> With single upper arm "RVS" <sup>4)</sup>
						1150	45.28	A_00901-T1	With 1x tool-actuation 'T' <sup>2)</sup> With single upper arms "RVS" <sup>4)</sup>
6	13.23	600	23.62	A_00904	<sup>2) 4)</sup>	1000	39.37	A_00906	<sup>2) 4)</sup>
		1000	39.37	A_00903	<sup>2) 4)</sup>	1250	49.21	A_00902	With single upper arms "RVS" <sup>2) 4)</sup>
					A_00902-T1			With 1x tool-actuation 'T' <sup>2)</sup> With single upper arms "RVS" <sup>4)</sup>	
12		1100	43.31	A_00908	<sup>2) 4)</sup>	600	23.62	A_00905-T1	<sup>2) 4)</sup>
					1100	43.31	A_00909	<sup>2) 4)</sup>	
15	33.07	1000	39.37	A_00092	<sup>2)</sup>				
				A_00092-T1	With 1x tool-actuation 'T'				
40	88.18	200	7.87	A_00094	<sup>2)</sup>				
		900	35.43	A_00090	<sup>2)</sup>				
				A_00091.01	Serial arrangement possible <sup>2) 3)</sup>				
				A_00091.01-T1	Serial arrangement possible <sup>3)</sup> With 1x tool-actuation 'T'				
				A_00091.01-T2	Serial arrangement possible <sup>3)</sup> With 2x tool-actuation 'T'				
				A_00091.01-T3	Serial arrangement possible <sup>3)</sup> With 3x tool-actuation 'T'				
		1000	39.37	A_00093-01	<sup>2)</sup>				
				A_00093-T1	With 1x tool-actuation 'T'				
		1300	51.18	A_00096-01	<sup>2)</sup>				

Double arm construction "RV..."



<sup>3)</sup> Serial arrangement

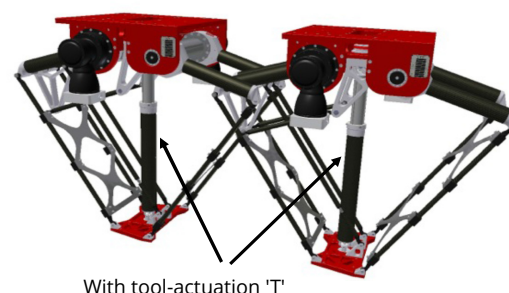

Tool-actuation 'TS'

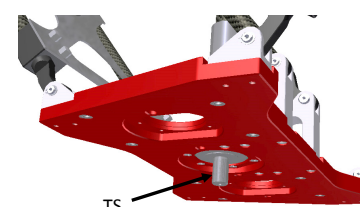

<sup>4)</sup> Single arm construction "RVS..."

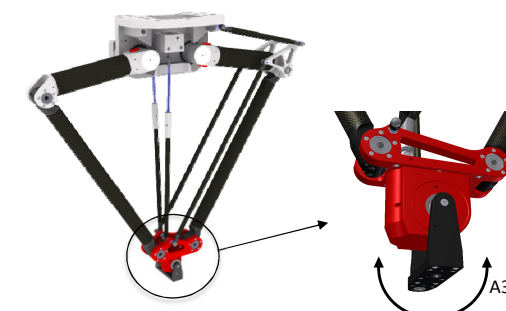

<sup>1)</sup> Please see separate overview for **autonox24** hygienic design robot mechanics.

<sup>2)</sup> Internal media supply is not possible.